

# Half Block Moulds

**Compatible With Concrete Lifting Inserts**

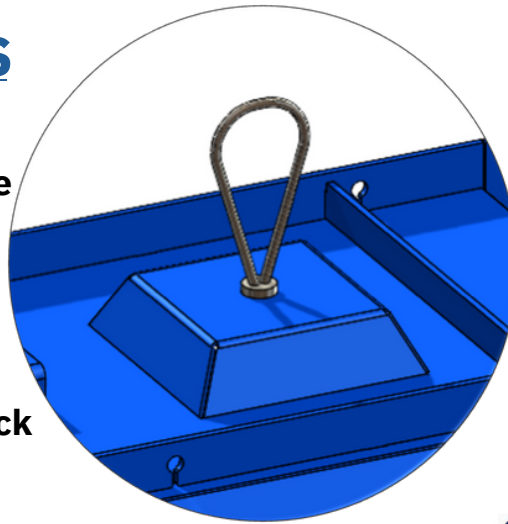

**Interlocking Block Design**

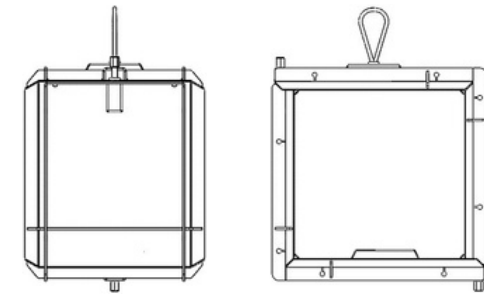

**705L x 680W x 700H**

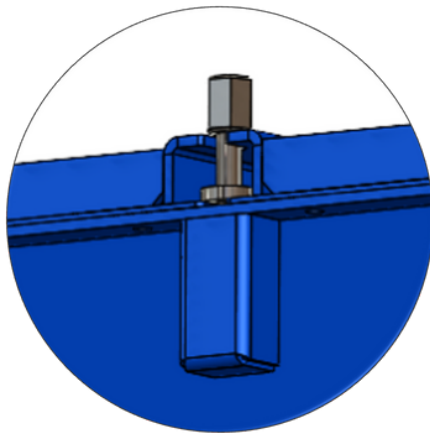

**Quick Release System For Splitting Moulds**

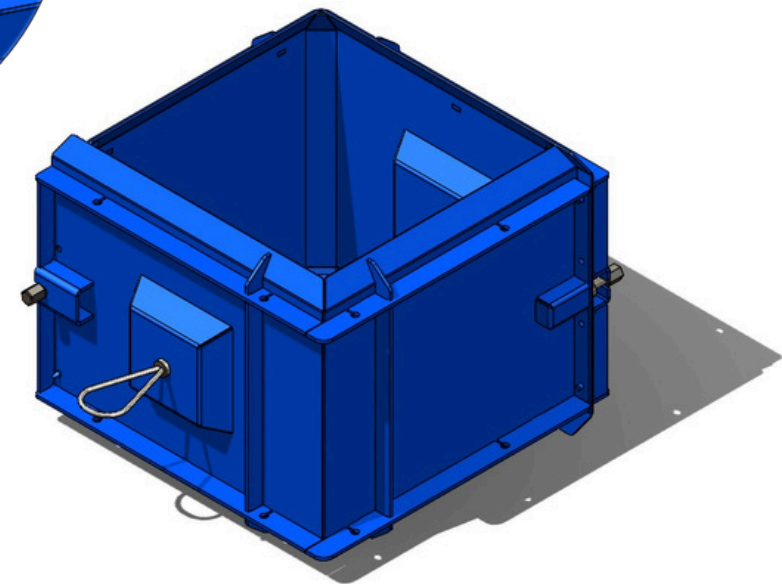

## TYPICAL USES OF BLOCKS:

- § Storage Bays For Aggregates / Agricultural / Scrap Merchants,
- § Recycling Centres For Material Segregation,
- § Traffic Calming / Road Barrier,
- § To Provide Security Boundaries

## Compatible With:

Kelly Blocks Flat Top Blocks Stair Blocks

Data for blocks produced from the moulds.

Mould No.	Size / mm	Mass / kg	Volume / m3	No. of Lifting Points
BMH-705-1	705	785	0.33	1

Cabragh Engineering